

## Product Sheet

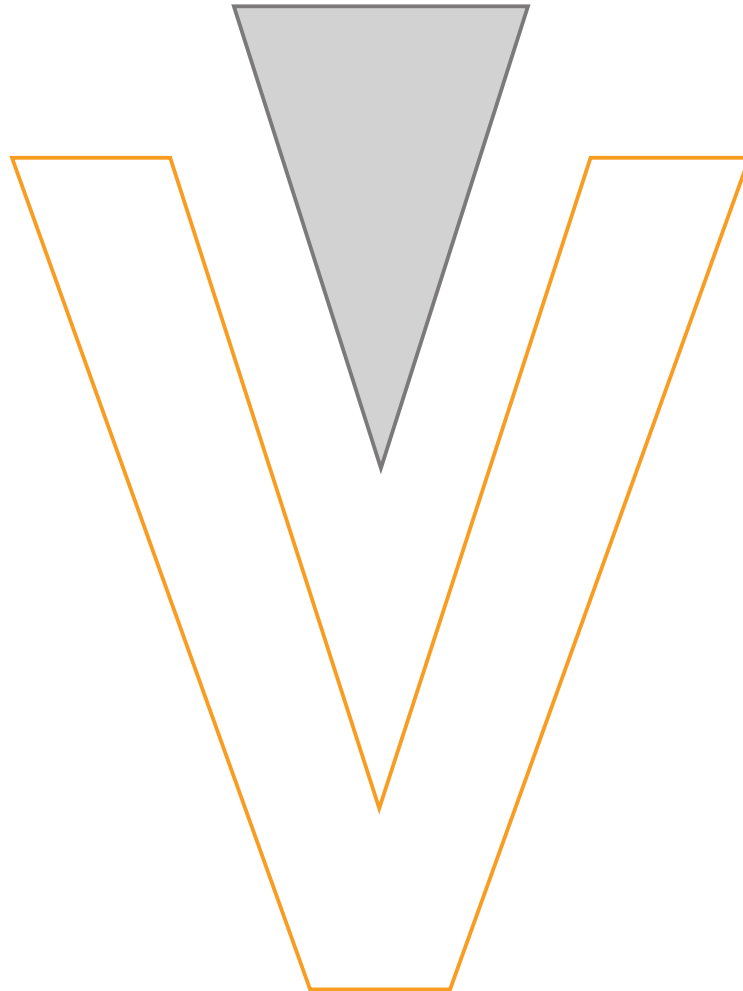

T-piece 45°

with welded branch

made of stainless steel

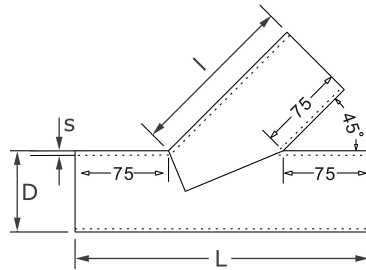

D	s	L	l	kg	Art.-Nr.
21,3	2,0	180	96	0,230	TP45-021X20-4
21,3	2,0	180	96	0,230	TP45-021X20-J
26,9	2,0	188	102	0,300	TP45-026X20-4
26,9	2,0	188	102	0,300	TP45-026X20-J
33,7	2,0	198	109	0,310	TP45-033X20-4
33,7	2,0	198	109	0,310	TP45-033X20-J
42,4	2,0	210	117	0,550	TP45-042X20-4
42,4	2,0	210	117	0,550	TP45-042X20-J
48,3	2,0	218	123	0,680	TP45-048X20-4
48,3	2,0	218	123	0,680	TP45-048X20-J
60,3	2,0	235	135	0,900	TP45-060X20-4
60,3	2,0	235	135	0,900	TP45-060X20-J
60,3	2,6	235	135	1,320	TP45-060X26-4
76,1	2,0	258	151	1,250	TP45-076X20-4
76,1	2,0	258	151	1,250	TP45-076X20-J
76,1	2,6	258	151	1,600	TP45-076X26-4
88,9	2,0	276	164	1,520	TP45-088X20-4
88,9	2,0	276	164	1,520	TP45-088X20-J
88,9	2,6	276	164	2,000	TP45-088X26-4
88,9	2,6	276	164	2,000	TP45-088X26-J
114,3	2,0	312	189	2,220	TP45-114X20-4
114,3	2,0	312	189	2,220	TP45-114X20-J
114,3	2,6	312	189	2,800	TP45-114X26-4
114,3	2,6	312	189	2,800	TP45-114X26-J
114,3	3,0	312	189	3,300	TP45-114X30-4
129,0	2,0	332	204	2,940	TP45-129X20-N
139,7	2,6	348	215	3,800	TP45-139X26-4
139,7	2,6	348	215	3,800	TP45-139X26-J
139,7	3,0	348	215	3,200	TP45-139X30-4
139,7	3,0	348	215	3,200	TP45-139X30-J
168,3	2,0	388	243	4,200	TP45-168X20-4
168,3	2,0	388	243	4,200	TP45-168X20-J
168,3	2,6	388	243	5,200	TP45-168X26-4
168,3	2,6	388	243	5,200	TP45-168X26-J
168,3	3,0	388	243	6,340	TP45-168X30-4
168,3	3,0	388	243	6,340	TP45-168X30-J
219,1	2,0	460	294	5,900	TP45-219X20-4
219,1	2,0	460	294	5,900	TP45-219X20-J
219,1	3,0	460	294	9,200	TP45-219X30-4
219,1	3,0	460	294	9,200	TP45-219X30-J
273,0	3,0	536	348	14,000	TP45-273X30-4
273,0	3,0	536	348	14,000	TP45-273X30-J
323,9	3,0	608	399	18,000	TP45-323X30-4

D	s	L	l	kg	Art.-Nr.
323,9	3,0	608	399	18,000	TP45-323X30-J
355,6	3,0	653	431	23,000	TP45-355X30-4
355,6	3,0	653	431	23,000	TP45-355X30-J
406,4	3,0	725	481	27,000	TP45-406X30-4
406,4	3,0	725	481	27,000	TP45-406X30-J

available material: 1.4307, 1.4404, 1.4571

45° / 30° branches > T-piece 45°

full description: T-piece 45°  
with welded branch  
ähnlich DIN EN 10253-3



### 45° T-piece

with welded branch

#### Feature

manufactured from welded pipe or sheet metal

laser cut

with butt-welded branch nozzles

MIG welded

immersion pickled

dimensional range DN 10 - DN 600

optional with 30° or 60° branch

optional with wall thicknesses up to 5,0mm

optional with reduced branches

materials 1.4307/304L - 1.4571 - 1.4404/316L

base material certificate acc. EN 10204/3.1

Varinox GmbH | Revision date 08.10.2025 | Revision number 31 ([s 139])

