

Product Sheet

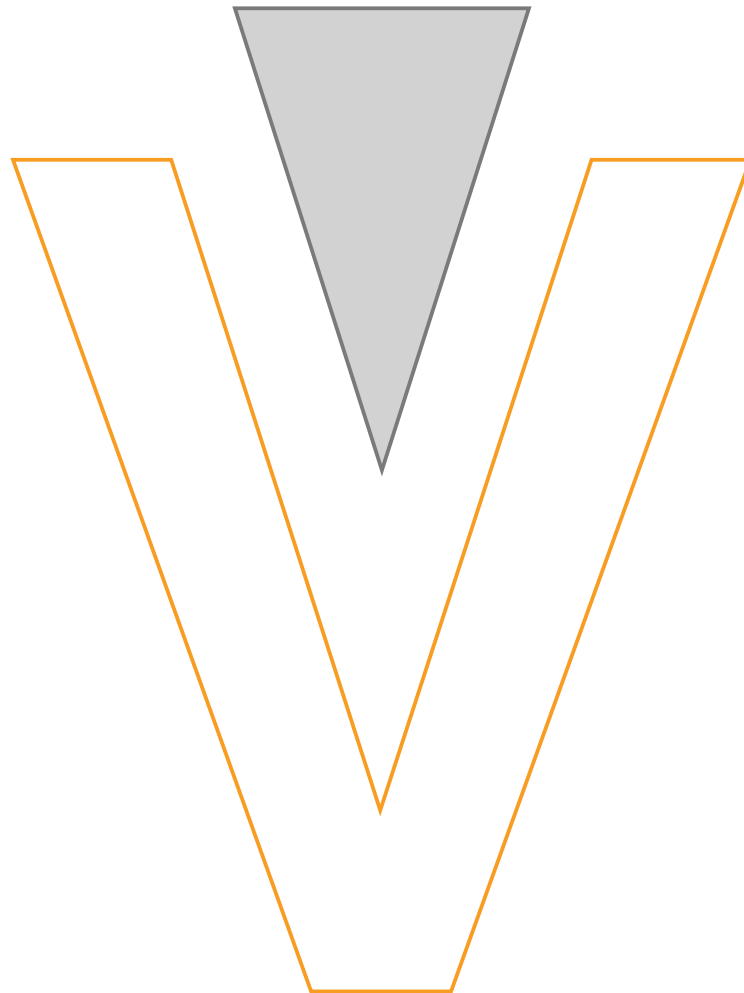

Branch saddle DIN 2618

short execution

made of stainless steel

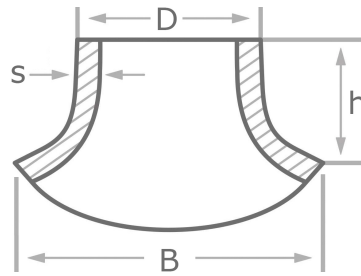

D	s	h	B	kg	Art.-Nr.
21,3	2,0	30	35	0,040	SD-021-020
26,9	2,6	30	45	0,050	SD-026-026
33,7	2,6	30	55	0,070	SD-033-026
42,4	2,6	35	70	0,110	SD-042-026
48,3	2,6	40	85	0,160	SD-048-026
60,3	2,9	45	100	0,300	SD-060-029
76,1	2,9	50	130	0,400	SD-076-029
88,9	3,0	60	155	0,600	SD-088-030
114,3	3,0	65	195	1,000	SD-114-030
139,7	3,0	85	245	1,330	SD-139-030
168,3	3,0	100	290	1,770	SD-168-030
219,1	3,0	135	375	3,000	SD-219-030

available material: 1.4571

Tees & Saddles > Saddles > made from tube

**Branch saddle****Feature**

short, pressed version

based on DIN EN 10253-2 (formerly known as DIN 2618)

pressed from welded pipes EN 10217-7

surface pickled

materials 1.4307 - 1.4571

base material certificate acc. EN 10204/3.1